

NPC 12-22 12V22AH

VRLA BATTERY



General purpose application series

Range Summary

Using oxygen recombination technology: maintenance-free
 PbCaSn alloy for plate grids: low self discharge rate than 3% per month
 High quality AGM separator: extend cycle life and prevent micro short circuit retardant
 High purity raw material: 99.99% pure lead



Application

Cable Television
 Communication
 Equipment
 Security System

UPS
 Control Equipment
 Medical Equipment
 Emergency Power



Battery Dimensions

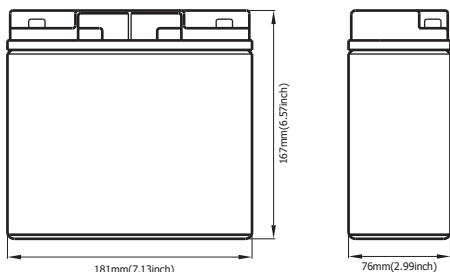

Terminal Dimensions

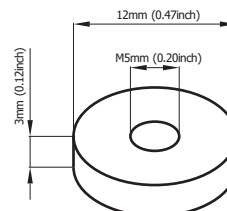

Technical Specifications

| | | | | |
|----------------------------------|---|-------------------|-----------------------|------------------|
| Battery Model | NPC12-22 | | | |
| Designed Floating Life | 5 Years | | | |
| Capacity(25°C) | 20HR(1.10A,1.80V) | 10HR(2.03A,1.80V) | 5HR(3.54A,1.75V) | 1HR(14.9A,1.60V) |
| | 22.0Ah | 20.3Ah | 17.7Ah | 14.9Ah |
| Dimensions | Length | Width | Height | Total Height |
| | 181mm(7.13inch) | 76mm(2.99inch) | 167mm(6.57inch) | 167mm(6.57inch) |
| Approx. Weight | 6.3Kg (13.86 lbs) | | | |
| Internal Resistance | Full charged at 25°C: 0.014 Ohm | | | |
| Self Discharge | 3% of capacity declined per month at (25°C) | | | |
| Capacity Affected by Temp.(20HR) | 40°C | 25°C | 0°C | -15°C |
| | 102% | 100% | 85% | 65% |
| Charge Voltage(25°C) | Cycle use | | Float use | |
| | 14.4-14.8V(-30mV/ °C), max. Current: 6A | | 13.6-13.8V(-20mV/ °C) | |

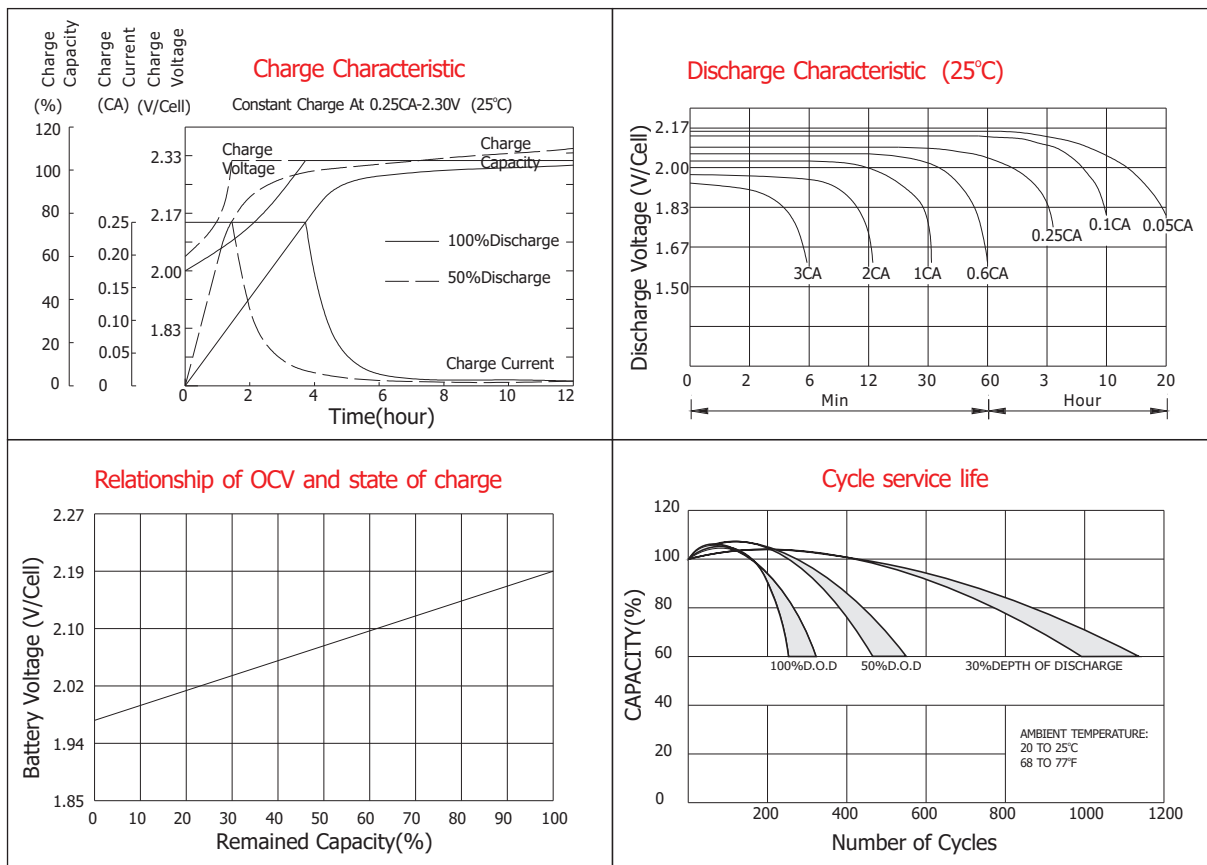

Constant current discharge ratings-amperes at 25°C

| F.V/Time | 5min | 10min | 15min | 30min | 1h | 3h | 5h | 10h | 20h |
|----------|------|-------|-------|-------|------|------|------|------|------|
| 1.60V | 85.1 | 62.6 | 46.4 | 28.3 | 14.9 | 6.33 | 3.78 | 2.11 | 1.23 |
| 1.67V | 82.5 | 59.3 | 44.6 | 27.1 | 14.7 | 6.08 | 3.70 | 2.09 | 1.19 |
| 1.70V | 75.6 | 57.2 | 43.6 | 24.6 | 14.2 | 5.68 | 3.62 | 2.08 | 1.17 |
| 1.75V | 74.1 | 55.4 | 42.2 | 23.4 | 13.5 | 5.49 | 3.54 | 2.06 | 1.14 |
| 1.80V | 71.3 | 52.9 | 38.3 | 21.6 | 12.7 | 5.27 | 3.33 | 2.03 | 1.10 |
| 1.85V | 62.9 | 50.4 | 34.4 | 19.9 | 11.8 | 5.08 | 3.12 | 2.00 | 1.08 |

Constant power discharge ratings-watts at 25°C

| F.V/Time | 5min | 10min | 15min | 30min | 1h | 3h | 5h | 10h | 20h |
|----------|------|-------|-------|-------|------|------|------|------|------|
| 1.60V | 154 | 113 | 84.7 | 51.0 | 25.4 | 10.6 | 6.97 | 4.22 | 2.46 |
| 1.67V | 149 | 110 | 83.6 | 49.9 | 25.2 | 10.3 | 6.94 | 4.19 | 2.38 |
| 1.70V | 143 | 109 | 82.9 | 46.7 | 24.8 | 9.83 | 6.85 | 4.17 | 2.35 |
| 1.75V | 141 | 109 | 82.2 | 45.3 | 24.3 | 9.60 | 6.79 | 4.12 | 2.29 |
| 1.80V | 129 | 105 | 76.3 | 43.2 | 22.9 | 9.32 | 6.58 | 4.07 | 2.19 |
| 1.85V | 117 | 100 | 69.2 | 39.8 | 21.6 | 9.04 | 6.17 | 4.01 | 2.14 |